

Safety Guide and Quick Installation Manual

Read this manual carefully before you use this machine and keep it handy for future reference. For safe and correct use, be sure to read “Safety Precautions for This Machine” in this manual before using the machine.



TABLE OF CONTENTS

- Introduction 1
 - Prior to Starting 1
 - How to Read the Manuals 1
 - Disclaimer 1
 - Notes 1
- Safety Symbols 3
 - Safety Precautions for This Machine 4
 - How to Read Safety Labels 4
 - Important Safety Precautions to Follow 4
 - Guidelines for unpacking products 4
 - Guidelines for locating and installing machines 4
 - Requirements for using cords and power plugs 5
 - Requirements during Emergencies 6
 - Requirements for using the machine 7
 - Requirements for handling the machine’s interior 7
 - Requirements for handling supplies 7
 - Guidelines for power connection 8
 - Adjustment 8
 - Removing the Fabric 8
 - Maintenance (Cleaning the Units and Disposing of Waste Ink) 9
 - This Machine’s Safety Labels 10
 - Positions of WARNING and CAUTION labels 10
 - Front 10
 - Back 10
 - Gloves and goggles 10

Waste ink bottle	11
Ink cartridge	11
Explanation of Power Switch Symbols	11
User's Notes	11
Information for This Machine	12
Laws and Regulations	12
Legal Restrictions	12
FCC Statement (USA)	12
Quick Installation Manual	14
Checking the Contents of the Package	14
About Manuals	14
Components Overview	15
Front and Right View	15
Rear View	15
Machine Installation	15
Preparation	15
Unpacking	17
Instructions for Waste Ink Bottle and Ink Cartridges Installation	17
Powering On	20
Installing the Platen	23
Network Connection	23
Ethernet Connection	23
Wi-Fi Antenna Connection	23
Handling of the Ink Cartridge	24
Information on ink cartridges	25
Instructions for ink cartridge usage	25
Instructions for Agitating a New White Cartridge	25
Proper Disposal of an Empty Ink Cartridge	27

Proper Handling of the Waste Ink Bottle	28
Information on the waste ink bottle	28
Proper Disposal of the Waste Ink and Waste Ink Bottle	28
Appendix	29
How to Inquire	29
Revision history	29
Trademarks	29

Introduction

This manual provides in-depth instructions and accompanying remarks on how to operate and utilize this machine. To ensure your safety, it is essential to thoroughly read this manual prior to using the machine. Store this manual in a convenient location for easy access and quick consultation.

Prior to Starting...

Only individuals with proper training should use the machine.

How to Read the Manuals

Disclaimer

The information provided in these manuals is subject to change without prior notice.

To the fullest extent permitted by applicable laws, the manufacturer shall not be held liable for any damages arising from machine failures, loss of registered data, or the use or non-use of the machine and accompanying operation manuals.

Ensure that you regularly create copies or keep backups of the data stored on this machine, as operational errors or machine malfunctions may result in the erasure of documents or data.

The manufacturer assumes no responsibility for any documents created or any outcomes resulting from data executed by users using this machine.

Notes

The manufacturer cannot be held responsible for any damages or expenses incurred from the use of non-genuine parts that were not obtained from the manufacturer of the product.











The manufacturer recommends that you use genuine ink from the manufacturer for optimal output quality.



Some illustrations in this manual may differ from the actual machine. Depending on the country, certain options may not be available. Please contact your local dealer for more information.

Specific units might be more optional depending on your country. Please contact your local dealer for more information.

Safety Symbols

Below Are the Safety Symbols and Their Meanings for This Machine

Symbol	Symbol meaning
	Prohibition
	Caution
	Warning; Pinch Point
	Caution, risk of electric shock
	Caution, risk of having hands or arms caught
	Keep out of reach of children
	Prohibition of disassembly
	See operating instructions. For details about the precautions in each location with this graphic symbol, see "This Machine's Safety Labels" in this manual.
	Wear eye protection
	Wear protective gloves

Symbol	Symbol meaning
	Do not touch
	Caution, hot surface

Safety Precautions for This Machine

How to Read Safety Labels

WARNING

Signifies a hazardous situation that could lead to severe injury or death if instructions are not adhered to.

CAUTION

Signifies a hazardous situation that could result in minor or moderate injury or damage to property if instructions are not adhered to.

Important Safety Precautions to Follow

Guidelines for unpacking products

WARNING

The following describes the warning messages on the plastic bag included in the packaging of this product:

Keep the polythene materials (bags, etc.) provided with this machine away from infants and young children. There is the risk of suffocation if polythene materials come into contact with the mouth or nose.

Guidelines for locating and installing machines

WARNING

To prevent the risk of fire or electric shock, refrain from performing the following actions near or within the vicinity of this machine:

- Utilizing flammable sprays, solvents, and similar substances
- Positioning flammable sprays, solvents, and similar substances
- Positioning containers holding liquids or small metal objects

CAUTION

To avoid the possibility of fire or electric shock, do not situate the machine in environments with high humidity or excessive dust accumulation.

For your safety, refrain from positioning the machine on an unstable or inclined surface. Placing it in such a manner may cause the machine to fall or tip over, potentially leading to injuries.

Guidelines for locating and installing machines

CAUTION

- To prevent the risk of fire due to overheating of internal components, ensure that the machine's vents are not blocked or obstructed.
- To avoid the risk of injury, do not place heavy objects on top of the machine, as this may cause it to tip over or fall.
- When operating this machine for an extended duration or producing a substantial volume of materials in a poorly ventilated or confined space, it is important to ensure adequate ventilation within the room.
- Maintain appropriate ventilation levels in the workplace to adhere to the occupational exposure guidelines (such as ACGIH) in the region. If necessary, utilize local ventilators to achieve the required ventilation. Recommended ventilation: 150 m³/h (The exact ventilation requirements may vary based on the installation environment.)
- Operate the machine at an altitude of 2,500 m or below. Using the machine in an environment exceeding this altitude may pose risks such as electric shock, electric leakage, or fire.

Requirements for using cords and power plugs

WARNING

To prevent the risk of fire or electric shock, please refrain from the following actions:

- Using any power supply voltage or frequencies that do not match the specified requirements
- Using multi-socket adaptors
- Using extension cords
- Making contact with the prongs of the power cable's plug with any metallic object

To prevent the risks of fire or electric shock, please avoid performing the following actions on power cords:

- Causing damage to them
- Bundling them tightly
- Making modifications to them
- Placing heavy objects on them
- Forcefully pulling them
- Exerting force to bend them

To avoid the risk of electric shock, refrain from handling the power cord plug with wet hands.

The provided power cord(s) is exclusively intended for use with this machine and should not be used with other applications. Additionally, using power cords other than the ones supplied with this machine may lead to fire or electric shock.

To prevent the risk of fire or electric shock, it is recommended to disconnect the plug and power cord from the wall outlet at least once a year for inspection. If any of the following conditions are present, discontinue the use of the plug and power cord and seek assistance from your dealer or service representative:

- The plug shows signs of burn marks.
- There are deformities on the prongs on the plug.
- The power cord's inner wires are exposed or broken.
- The power cord's coating is cracked, dented, or damaged.
- The power turns off and on when the power cord is bent.
- Any part of the power cord becomes hot.

CAUTION

- When unplugging the power cord from the wall outlet, ensure that you pull the plug directly and not the cord itself. Avoid forcefully pulling the power cord as it may cause damage, potentially leading to fire or electric shock.
- Always ensure that the power cord plug is fully inserted into the wall outlet. Avoid inserting it into loose or unstable outlets that may lead to poor contact, as this can result in heat generation.
- Regularly disconnect the plug from the wall outlet and clean both the prongs and the surrounding area at least once a year. Allowing dust to accumulate on the plug poses a fire hazard.

Power source

100-120 Vac, 1.1 A or more, 50/60 Hz

The voltage should remain within a 10% fluctuation range.

Please ensure that the power cable is connected to a power source as described above.

Verify that the wall outlet is in close proximity to the machine and easily accessible so that it can be unplugged effortlessly in case of an emergency.

Requirements during emergencies

WARNING

In the event of a nearby lightning strike, refrain from touching this machine to avoid the risk of electric shock.

Ensure that the machine is installed in close proximity to a wall outlet to enable easy disconnection of the power cord plug during emergency situations.

If the machine exhibits any of the following unusual behaviors, promptly turn off the power. After powering off, ensure that you disconnect the power cord plug from the wall outlet and contact your service representative to report the issue. Continuing to use the power cord can lead to the risk of fire or electric shock.

- Smoke is being emitted from the machine.
- Unusual odors are emitted from the machine.
- Metal objects or foreign objects have fallen inside the machine.
- Water or other fluids have entered the machine.

In the event that the machine topples over or if a cover or any other part is damaged, promptly turn off the power. After disconnecting the power cord plug from the wall outlet, contact your service representative for assistance. Continuously operating the machine under such conditions may lead to the risk of fire or electric shock.

CAUTION

- The machine weighs about 110 kg (242.5 lb.).
- It is necessary to have a minimum of four individuals to lift the printer. When transporting the printer, lift it carefully to avoid straining yourself. Forcing or handling the printer roughly, resulting in dropping it, poses a risk of injury.

- Before moving the machine, ensure that it is unplugged. Exercise caution to prevent the power cord from becoming entangled under the machine during the relocation process. Neglecting these precautions may lead to the risk of fire or electric shock.
- When raising or lowering the front cover, make sure to grasp it from the indicated area. Exercise caution to prevent your hand or any other body part from getting trapped in the front cover.

Requirements for using the machine

CAUTION

- Ensure that children are kept at a safe distance from the machine. Otherwise, there is a risk of their hands or fingers getting trapped in the gaps, potentially leading to injury.
- Ensure that only authorized operators are near the machine. Allowing other individuals close to the machine may lead to the risk of hands or fingers getting caught in the gaps, resulting in injury.
- Ensure that USB flash memory devices are kept away from children's reach. In the event of a child accidentally swallowing a USB flash memory device, promptly seek medical attention.

Requirements for handling the machine's interior

WARNING

- Do not remove any covers or screws unless explicitly specified in the User Manual.
- Prior to removing the cover, ensure that you have turned off the power switch located at the rear of the machine. Removing the cover while the power is on or removing unauthorized parts may pose the risk of electric shock.
- Under no circumstances should you attempt to disassemble or modify this machine. Engaging in such actions carries the risk of burns and electric shock.

CAUTION

- Avoid lifting the cover while the machine is in operation. Doing so can result in your hand or fingers becoming trapped in the machine, potentially causing injury.

Requirements for handling supplies

CAUTION

- When dealing with ink, cleaning solution, or pretreatment liquid, carefully adhere to the instructions provided in the manual for proper usage.
- In the event of swallowing, inhaling, or eye contact with ink, cleaning solution, or pretreatment liquid, refer to the relevant safety data sheet (SDS) for proper guidance.
- To avoid getting stained by ink or cleaning solution, it is advisable to wear appropriate protective gear such as protective gloves, protective glasses or goggles, and protective clothing. Additionally, exercise caution to prevent staining the surrounding area when handling or agitating the ink.
- Store ink, cleaning solution, and pretreatment liquid in a cool and well-ventilated location that is inaccessible to children.
- Ensure that waste ink, containers used for ink, cleaning solution, pretreatment liquid, and any components that have come into contact with ink are kept beyond the reach of children.
- When dealing with ink, cleaning solution, or pretreatment liquid, take precautions to prevent contact with your clothing. In the event of any stains, promptly wash the affected area with cold water.
- During the replacement of a cartridge containing ink, cleaning solution, or pretreatment liquid, be cautious not to allow any spills or stains on clothing. If you do, rinse the stained area with cold water.

- If replacing a cartridge that contains ink, cleaning solution, or pretreatment liquid, prevent any contact with your skin. If an accident occurs, thoroughly cleanse the affected area with soap and water.
- When removing a cartridge that contains ink, cleaning solution, or pretreatment liquid, don't place your hand near the cartridge's installation area, including the ink supply nozzle and its immediate surroundings. If any substance contacts your hands, wash them thoroughly using soap and water.
- Take caution to prevent ink stains as the surface of the ink cartridge may have ink residue.
- Avoid removing the cartridge while the machine is in operation to prevent ink spray that can stain clothes and the surrounding area. If any substance comes into contact with your hands, wash them thoroughly using soap and water.
- Avoid disassembling a cartridge that contains ink, cleaning solution, or pretreatment liquid as it may result in ink or cleaning solution stains on your hands and fingers.
- Exercise caution and be mindful of your surroundings and the potential for ink stains when shaking a cartridge containing ink, cleaning solution, or pretreatment liquid. Failure to do so may lead to injury or stains on household items.
- Avoid hitting or dropping it when agitating, as it can result in injury, cartridge damage, or ink leakage.
- Do not excessively shake the cartridge, as it may cause ink leakage.
- Agitate/shake according to instructions. Using alternative methods may cause ink leakage.
- Ensure that you wear appropriate commercially available protective glasses, gloves, and clothing when handling or replacing cartridges.

Guidelines for power connection

WARNING

- When using a UPS (Uninterruptible Power Supply) in conjunction with this product, it is essential to verify that the output power meets the necessary requirements. Insufficient output power can result in hazardous situations such as smoking or fire within the UPS. Take the time to carefully read and follow the instructions provided by the UPS, paying close attention to the rated output power. If you have any questions or concerns, reach out to your authorized dealer for assistance.
- When using a surge protector with this product, be aware that long-term use may cause the surge protector to malfunction or pose a fire hazard due to varistor deterioration. Read and follow the surge protector instructions carefully and contact your dealer if you have any questions.

Adjustment

CAUTION

- Exercise caution to prevent your hands or fingers from getting caught when moving the platen to avoid the risk of injury.

Removing the fabric

CAUTION

- Take care to avoid any contact between your hand or body and the ink when removing the fabric. In case of skin contact with ink, cleanse the affected area thoroughly using soap and water. If ink stains your clothing, rinse the stained area with cold water.

Maintenance (Cleaning the Units and Disposing of Waste Ink)

CAUTION

- During maintenance procedures, the carriage may move when the front cover is open. It is important to avoid touching the carriage while it is in motion to prevent any risk of injury.
- To ensure proper maintenance and prevent any potential injury or malfunction, carefully follow the procedures outlined in the user's manual. Pay close attention to securely installing parts and covers to guarantee reliable operation.
- Exercise caution while using a screwdriver to avoid any potential injury caused by the tip of the screwdriver.
- In case of contact between the waste ink and your eyes, promptly rinse them with running water and seek medical attention if needed.
- Ensure that the waste ink bottle is kept in a location inaccessible to children.
- Make sure to store waste ink, ink containers, cleaning solutions, pretreatment liquids, and any components that have come into contact with ink in a place that is inaccessible to children.
- When replacing a waste ink bottle, take care not to get any liquid on your clothing. If any spills occur, promptly wash the stained area with cold water.
- When replacing a waste ink bottle, ensure that you prevent any contact with your skin. In case of accidental contact, thoroughly cleanse the affected area with soap and water.

CAUTION

When performing the following maintenance tasks, it is important to wear commercially available goggles and gloves:

- Cleaning the maintenance unit, head nozzle plate, wiper, left ink sump, encoder sheet, and guide rod.
- Replacing the left and right ink sump, ink supply unit, maintenance unit, ink cartridges, and waste ink bottle.

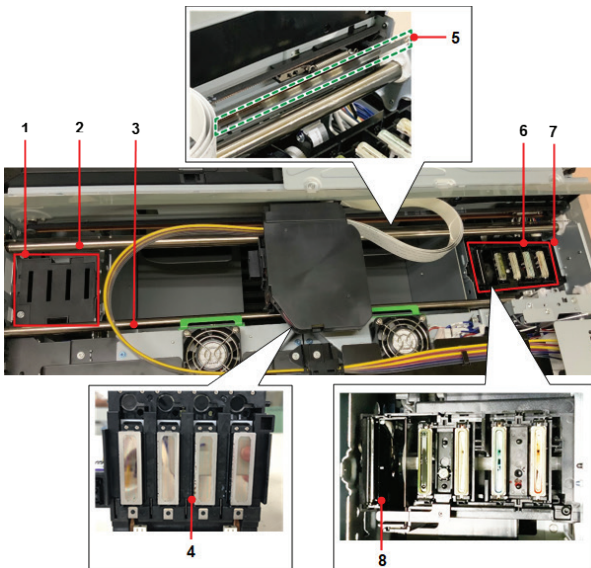

1. Left ink sump
2. Guide rod: Main
3. Guide rod: Front
4. Head Nozzle Plate*
5. Encoder Sheet
6. Maintenance unit
7. Right ink sump**
8. Wiper

* Located behind the carriage

** Located under the maintenance unit

This Machine's Safety Labels

Below are the machine's safety precaution labels.

Positions of **WARNING** and **CAUTION** labels

This machine has **WARNING** and **CAUTION** labels at the positions shown below. To ensure safety, please adhere to the instructions provided and handle the machine as indicated.

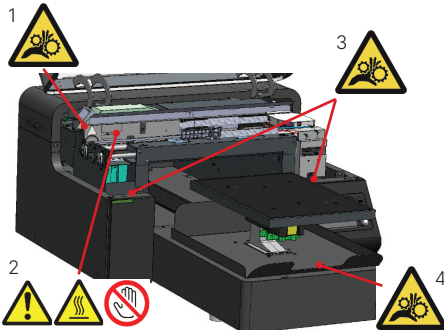

FRONT

1. Exercise caution to prevent your hands or any other body part from being caught by the carriage.
2. Take note that certain labeled parts within the machine may be hot. Avoid touching these areas as it may lead to injury.
3. Be mindful to prevent your hands or other body part from being caught by the platen.
4. Moving components can crush and cut, so keep your hands clear. Do not operate the machine without the necessary guards in place.



BACK

1. This label is meant for customer engineers.
CAUTION: DOUBLE POLE/NEUTRAL FUSING
Mains will be disconnected to de-energize the phase conductors.

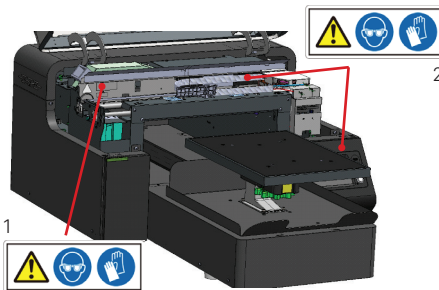
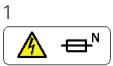

GLOVES AND GOGGLES

- 1 to 3. Make sure you wear commercially available gloves and goggles.





Waste ink bottle
Ensure the waste ink bottle is not in reach of children.

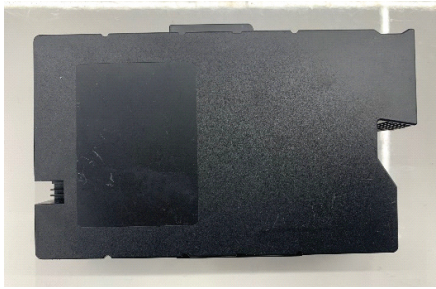

Ink cartridge
Ensure that the ink cartridge is kept inaccessible to children and refrain from disassembling it.

Explanation of Power Switch Symbols

Symbol	Symbol meaning
	POWER ON
○	POWER OFF
⏻	STANDBY

User's Notes

- Do not touch the carriage during operation, and do not insert your hand into the gap between the front cover and platen.
- Refer to the User Manual for detailed instructions on operating the heat press device.
- Take care to prevent ink stains on your clothing when removing the fabric. In case of contact, promptly wash the affected area with cold water.

Information for This Machine

Laws and Regulations

Legal Restrictions

Please refrain from copying or printing any materials that are prohibited by law. It is generally prohibited by local law to copy or print items such as bank notes, revenue stamps, bonds, stock certificates, bank drafts, checks, passports, and driver's licenses. Please note that the provided list is not exhaustive and serves as a general reference. We do not guarantee its completeness or accuracy. If you have any doubts about the legality of copying or printing specific items, we recommend consulting with a legal advisor.

FCC Statement (USA):

Note: This equipment has been tested and found to comply with the limits for a Class A digital device, pursuant to Part 15 of the FCC Rules. These limits are designed to provide reasonable protection against harmful interference when the equipment is operated in a commercial environment. This equipment generates, uses and can radiate radio frequency energy and, if not installed and used in accordance with the instruction manual, may cause harmful interference to radio communications. Operation of this equipment in a residential area is likely to cause harmful interference in which case the user will be required to correct the interference at his own expense.

Caution: Changes or modifications not expressly approved by the party responsible for compliance may void the user's authority to operate the equipment.

Supplier's Declaration of Conformity

This device complies with part 15 of the FCC Rules.

Operation is subject to the following two conditions:

- (1) This device may not cause harmful interference, and
- (2) This device must accept any interference received, including interference that may cause undesired operation.

Responsible party: Ricoma International Corporation

Address: 11555 NW 124th Street Miami, FL 33178

Telephone number: 305-418-4421

Product name: Ricoma Vision DTG Printer

Quick Installation Manual

Checking the Contents of the Package

The following contents are packaged with the product. Make sure all of these contents are included..

- Product
- Power cord
- Ethernet cable
- Waste ink bottle
- Waste ink tube
- Platen (Medium)
- Frame (Medium)
- Safety Precautions and Quick Installation Manual
- User Maintenance Precautions
- Squeegee
- Heat press paper
- Cleaning liquid
- Cleaning applicators (1 set)
- Lint free wipes (1 set)
- Polyethylene gloves (5 sets)
- Grease
- Cleaning jig
- Head protection cover

Inside the printer box, you will find an Accessory Box containing all the items apart from the printer itself. It is recommended to keep the accessory items readily accessible for future use.

NOTE: The basic accessory kit provided with the printer may include additional items specific to your package.

About Manuals

To learn more about operating, maintaining, adjusting settings, and resolving issues with this machine, refer to the User Manual.

For any inquiries, please reach out to your sales or service representative.

Components Overview

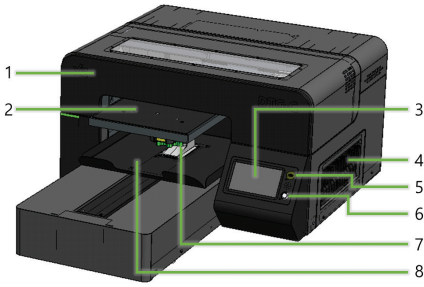

- 1) Front cover
- 2) Platen
- 3) Touch panel
- 4) Ink cartridges
- 5) USB-A port (2.0)
- 6) Sub power button
- 7) Platen adjustment wheel and scale
- 8) Table tray

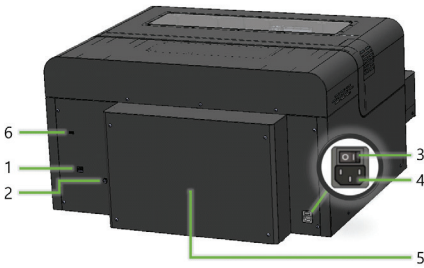

- 1) Ethernet port
- 2) Waste ink bottle connector
- 3) Main power switch
- 4) Power connector
- 5) Rear cover
- 6) USB-A port (2.0)*

*In case the USB-A port on the front is unavailable, utilize the USB-A port on the back. When connecting via USB, insert a USB memory stick into either port, but not both simultaneously.

Machine Installation

Preparation

WARNING

To prevent the risk of fire or electric shock, it is important to refrain from performing the following actions near or inside this machine:

- Using or applying flammable sprays, solvents, or similar substances
- Placing flammable sprays, solvents, or similar substances near the machine
- Placing containers containing liquids or small metal objects near the machine

CAUTION

- To ensure safety and prevent the risk of fire or electric shock, do not position the machine in environments that are excessively humid or dusty.
- To prevent potential accidents and injuries, avoid placing the machine on surfaces that are unstable or tilted, as it may lead to the machine falling or toppling over.

- To prevent risks of fire from overheated internal components, do not obstruct the machine's vents.
- To ensure safety and prevent injury, refrain from placing heavy objects on top of the machine, as this may cause it to become unstable and potentially topple over.
- To maintain a safe working environment and avoid potential issues, it is important to ensure adequate ventilation when using this machine for an extended period of time or when producing a large volume of prints in a poorly ventilated or confined space.
- Maintain appropriate ventilation levels in the workplace to adhere to the occupational exposure guidelines (such as ACGIH) in the region. If necessary, utilize local ventilators to achieve the required ventilation.
- Recommended ventilation: 150 m³/h (The exact ventilation requirements may vary based on the installation environment.)
- Operate the machine at an altitude of 2,500 m or below. Using the machine in an environment exceeding this altitude may pose risks such as electric shock, electric leakage, or fire.
- Ensure a stable and dependable power supply by using a UPS if your area's power is unreliable.
- Keep an electronic hygrometer/thermometer close to the printer at all times to monitor and maintain a temperature range of 15°C to 32°C (59°F to 90°F) in the operating room.
- If the relative humidity falls below 45%, use a humidifier to increase the humidity level. The recommended humidity range is 45% to 80% RH, non-condensing.
- Position the machine in close proximity to the power source while allowing for the necessary clearance areas indicated. These clearance areas are crucial for the functioning and maintenance of the machine.

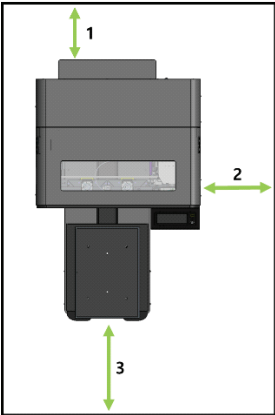

1. Rear: 10 cm (3.9 inches) or more
2. Right: 70 cm (27.6 inches) or more
3. Front: 50 cm (19.7 inches) or more

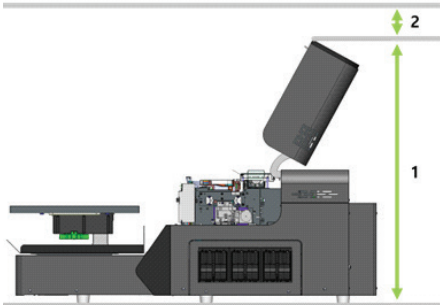

1. Max. height: 100 cm (approx. 39.4 inches)
2. Above: 10 cm (3.9 inches) or more

- Heat Press or conveyer dryer for heat curing the ink (THIS NEEDS ITS OWN CIRCUIT)
- Stable, Sturdy, and Level Table for the 110 kg (242.5 lb.) printer.
- Computer with Windows 10 or Windows 11 operating system.
- Graphics software installed in the computer, such as Photoshop, CorelDraw, Photoshop Elements, or Illustrator.
- High Volume Low Pressure (HVLP) electric sprayer or another type of sprayer for applying pretreatment for dark garments.

Unpacking

CAUTION

- The machine weighs about 110 kg (242.5 lb.).
- It is necessary to have a minimum of four individuals to lift the printer. When transporting the printer, lift it carefully to avoid straining yourself. Forcing or handling the printer roughly, resulting in dropping it, poses a risk of injury.
- Ensure the shipping box is in the proper orientation. (Indicated by arrows on the shipping box.)
- Unwrap and remove the poly wrap and strapping from the printer.
- Take off the top lid, upper foam, and separator sleeve.
- Position the printer on your table.
- **IMPORTANT!** Lift from the box with the help of 4 people. Do not lift by the platen or platen base.
- Using four or more people, firmly grasp the indentations located at the base of the machine's sides for lifting. Take care to lift and carry the machine in a slow and cautious manner.

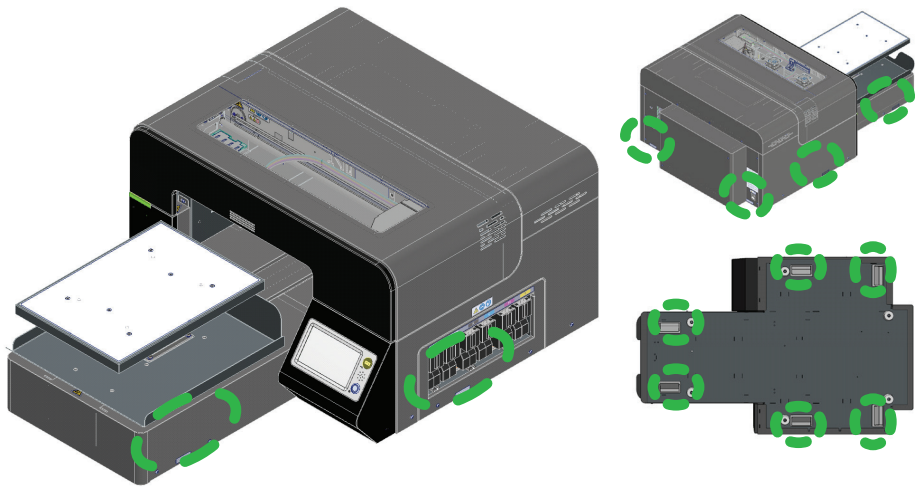

Instructions for Waste Ink Bottle and Ink Cartridges Installation

- **IMPORTANT!** Ensure that the waste ink bottle is securely connected to the printer. The printer does not have the capability to detect the connection of the waste ink bottle.
- Insert the tube through until it reaches the position of the stopper on the inner side of the waste ink bottle cap.

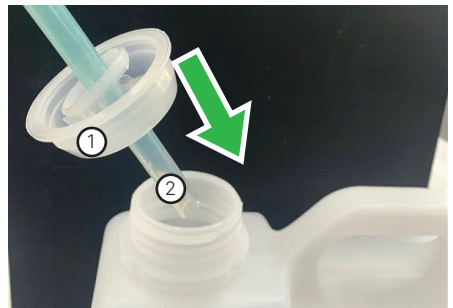

1. Waste ink bottle cap
2. Waste ink tube

- Close the cap of the waste ink bottle. Ensure that the waste ink bottle cap is tightly closed, leaving no gaps between the cap and the bottle.



- Unfasten the tape and remove the towel from the waste ink bottle connector, then proceed to connect the waste ink tube to the waste ink bottle connectors located on the right rear side of the printer.

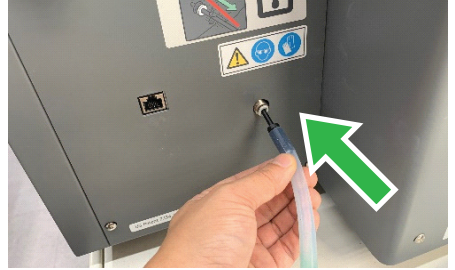

- **IMPORTANT!** Insert the waste ink tube into the waste ink bottle connector until the marking on the tube is no longer visible.

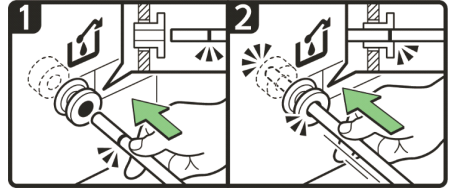

- Use tape to firmly secure the waste ink bottle in an upright position.



- **IMPORTANT!** Ensure that the waste ink bottle is installed in a vertical position. Installing it horizontally may cause the waste ink to leak.



- Ensure that the waste ink tube is connected in a manner that allows the ink to flow vertically from the printer's top to the waste ink bottle at the bottom. Reversing the top-to-bottom orientation at any point can disrupt the smooth flow of waste ink and potentially result in a malfunction.

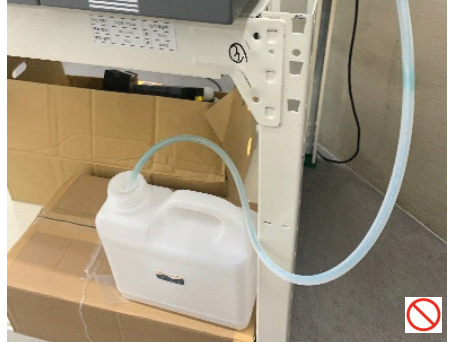

- Make sure to connect the waste ink tube directly to the waste ink bottle in a straight manner. Avoid bending or twisting the tube, as this can lead to ink clogging inside the tube and potentially cause a malfunction.

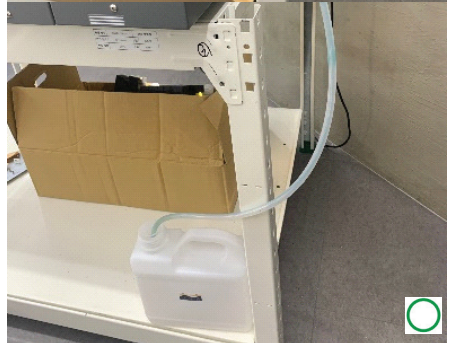

- Agitate the new white cartridges. For further information on agitating a new white cartridge, see page 34, "Instructions for Agitating a New White Cartridge."

- Install the ink cartridges.





- **IMPORTANT!** When installing the ink cartridges, avoid touching the interior of the machine.
- Carefully insert the cartridge in the correct position.
- During the initial ink charging, refrain from lifting the front cover or cartridge cover.
- If you accidentally lift the cover during the initial ink charge, the procedure will pause. To resume, press and hold the power button down to reboot the printer.
- Before inserting the white cartridges into the printer, agitate them thoroughly and then begin the filling process.
- For white ink, place two white ink cartridges into the printer.
- You can place each ink cartridge into either of the designated slots. Follow the instructions below to supply the ink:

Powering On

WARNING

To prevent the risk of fire or electric shock, please refrain from the following actions:

- Using any power supply voltage or frequencies that do not match the specified requirements
- Using multi-socket adaptors
- Using extension cords
- Making contact with the prongs of the power cable's plug with any metallic object

To prevent the risks of fire or electric shock, please avoid performing the following actions on power cords:

- Causing damage to them
- Bundling them tightly
- Making modifications to them
- Placing heavy objects on them
- Forcefully pulling them
- Exerting force to bend them

To avoid the risk of electric shock, refrain from handling the power cord plug with wet hands.

The provided power cord(s) is exclusively intended for use with this machine and should not be used with other applications. Additionally, using power cords other than the ones supplied with this machine may lead to fire or electric shock.

To prevent the risk of fire or electric shock, it is recommended to disconnect the plug and power cord from the wall outlet at least once a year for inspection. If any of the following conditions are present, discontinue the use of the plug and power cord and seek assistance from your dealer or service representative:

- The plug shows signs of burn marks.
- There are deformities on the prongs on the plug.
- The power cord's inner wires are exposed or broken.
- The power cord's coating is cracked, dented, or damaged.
- The power turns off and on when the power cord is bent.
- Any part of the power cord becomes hot.

CAUTION

When unplugging the power cord from the wall outlet, ensure that you pull the plug directly and not the cord itself. Avoid forcefully pulling the power cord as it may cause damage, potentially leading to fire or electric shock.

Always ensure that the power cord plug is fully inserted into the wall outlet. Avoid inserting it into loose or unstable outlets that may lead to poor contact, as this can result in heat generation.

Regularly disconnect the plug from the wall outlet and clean both the prongs and the surrounding area at least once a year. Allowing dust to accumulate on the plug poses a fire hazard.

- Plug the power cord into the power connector.
- Activate the main power switch.



- Press and hold the sub power button for a minimum of 2 seconds.



If the ink is not charged, the printer will initiate the initial ink charging process upon booting.

The initial ink charging process takes about 20 minutes to complete.

NOTE – During this process, do not lift the front cover. In the event that the initial ink charging is paused due to lifting the front cover, simply hold down the sub power button to reboot.

After the completion of the initial ink charge, the touch screen will display the message “Ready” in the upper left-hand corner.

Once the initial ink charging is completed, proceed to the next step.



Installing the Platen

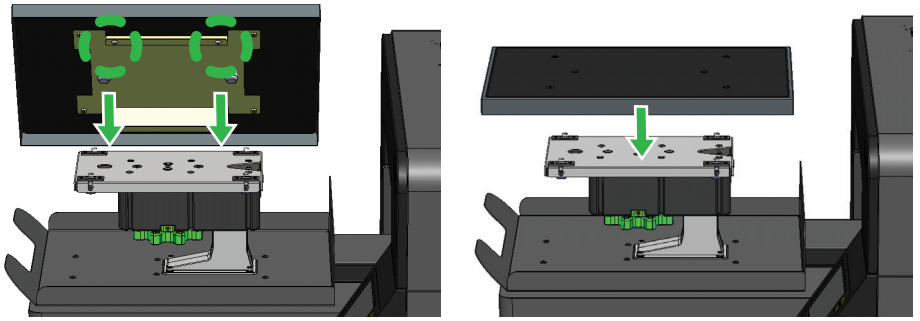

- Attach the platen.
- Install the platen by ensuring that the two protrusions on its back align correctly with the corresponding holes in the platen base.
- Pay attention to the guide-shaped hole on the back of the platen base.
- When positioning the platen, it is recommended to insert the pin from the front of the machine for easier placement.

Network Connection

Place the ethernet cable into the Ethernet port or connect via Wi-Fi.

IMPORTANT! This system is designed to support an automatic software update feature. Therefore, the system needs to be connected to the internet to receive the automatic software updates. This will ensure continuous printer debugging and quality performance.

In order to keep in optimal condition, be sure to connect to internet via ethernet or Wi-Fi.

1. Ethernet Connection



OR

2. Wi-Fi Antenna Connection



Refer to 1.6 Printer Setup in the User Manual.

IMPORTANT! The Wi-Fi Antenna must be the product below. Other products are not compatible.

- Manufacturer: TP-LINK
- Model Name: Archer T3U Plus

- Configure the network settings.
- Refer to the User Manual for detailed instructions on configuration.

Handling of the Ink Cartridge

WARNING

The warning messages on the plastic bag included in the packaging of this product are as follows:

- Keep the polythene materials (bags, etc.) provided with this machine away from infants and young children to prevent suffocation. Polythene materials can pose a risk if they come into contact with the mouth or nose.

CAUTION

- Adhere to the instructions provided in the manual for proper handling of ink, cleaning solution, and pretreatment liquid.
- In the event of swallowing, inhaling, or eye contact with ink, cleaning solution, or pretreatment liquid, refer to the relevant safety data sheet (SDS) for proper guidance.
- To avoid getting stained by ink or cleaning solution, it is advisable to wear appropriate protective gear such as protective gloves, protective glasses or goggles, and protective clothing. Additionally, exercise caution to prevent staining the surrounding area when handling or agitating the ink.
- Store ink, cleaning solution, and pretreatment liquid in a cool and well-ventilated location that is inaccessible to children.
- Ensure that waste ink, containers used for ink, cleaning solution, pretreatment liquid, and any components that have come into contact with ink are kept beyond the reach of children.
- When handling ink, cleaning solution, or pretreatment liquid, take precautions to prevent contact with your clothing. In the event of any stains, promptly wash the affected area with cold water.
- During the replacement of a cartridge containing ink, cleaning solution, or pretreatment liquid, be cautious not to allow any spills or stains on clothing. If you do, rinse the stained area with cold water.
- If replacing a cartridge that contains ink, cleaning solution, or pretreatment liquid, prevent any contact with your skin. If an accident occurs, thoroughly cleanse the affected area with soap and water.
- When removing a cartridge that contains ink, cleaning solution, or pretreatment liquid, don't place your hand near the cartridge's installation area, including the ink supply nozzle and its immediate surroundings. If any substance contacts your hands, wash them thoroughly using soap and water.
- Take caution to prevent ink stains as the surface of the ink cartridge may have ink residue.
- Avoid removing the cartridge while the machine is in operation to prevent ink spray that can stain clothes and the surrounding area. If any substance comes into contact with your hands, wash them thoroughly using soap and water.
- Avoid disassembling a cartridge that contains ink, cleaning solution, or pretreatment liquid as it may result in ink or cleaning solution stains on your hands and fingers.
- Exercise caution and be mindful of your surroundings and the potential for ink stains when shaking a cartridge containing ink, cleaning solution, or pretreatment liquid. Failure to do so may lead to injury or stains on household items.
- Avoid hitting or dropping it when agitating, as it can result in injury, cartridge damage, or ink leakage.
- Do not excessively shake the cartridge, as it may cause ink leakage.
- Agitate/shake according to instructions. Using alternative methods may cause ink leakage.
- Ensure that you wear appropriate commercially available protective glasses, gloves, and clothing when handling or replacing cartridges.

IMPORTANT! In case the ink cartridge remains empty for an extended period, it will not be possible to carry out maintenance for the print head, which can lead to printer malfunctions. To avoid this, ensure you have a new ink cartridge on hand and promptly install it when prompted by the replacement message.

Information on ink cartridges

To ensure safety and reliability, it is important to use genuine ink cartridges that comply with the manufacturer's safety specifications.

Never reuse the ink cartridges.

Instructions for ink cartridge usage

Avoid opening the ink cartridge package until you are ready to install it in the machine.

Refrain from touching the ink inlets or chip contacts on the ink cartridges.

Do not attempt to disassemble the ink cartridges.

Prior to installation, verify the color of the ink cartridge.

Only remove an ink cartridge if absolutely necessary after installation.

Do not remove an ink cartridge while printing is in progress, as it will halt the printing process.

Instructions for Agitating a New White Cartridge

Before attaching a new white ink cartridge to the printer, ensure you agitate the white ink by shaking it gently.

It is important to agitate the white ink on a daily basis. A reminder message will appear every 12 hours, prompting you to agitate the cartridge. When this message appears, follow the instructions to shake the white ink cartridge.

White ink has a tendency to experience ink precipitation, where the ink accumulates at the bottom of the ink solution. Ink precipitation may lead to decreased print density or nozzle clogging. Make sure to agitate the white ink when unpacking and continue doing so once daily thereafter.

IMPORTANT! Print head nozzle issues may arise if you fail to follow these procedures.

Make sure you shake the cartridge gently.

The recommended method for agitation is as follows:

- Ensure that you wear appropriate commercially available protective glasses, gloves, and clothing when handling or replacing cartridges to avoid being stained by the ink.

Prepare

- To clean the white ink cartridge and cartridge slot, use a lint-free wipe to remove any dirt or debris. Refer to the User Manual for detailed instructions on how to clean them properly. Additionally, inspect the white ink cartridge for any tears or cracks to ensure its integrity.

Agitate the ink

- Hold the cartridge as illustrated in Figure 1.
- Hold the white ink cartridge with the ink supply port facing upwards.
- Shake the ink cartridge by tilting it side to side, as illustrated below.
- Shake the cartridge for 50 seconds with 2 back-and-forth shakes per second.

Once the ink is agitated, use a clean cloth to remove any ink stains from the ink supply port.



Proper Disposal of an Empty Ink Cartridge

Ensure proper disposal of depleted ink cartridge and cleaning cartridge in compliance with relevant laws and regulations. If you have any doubts or questions regarding disposal, please seek guidance from your local dealer.

Proper Handling of the Waste Ink Bottle

CAUTION

- In case of contact between the waste ink and your eyes, promptly rinse them with running water and seek medical attention if needed.
- Ensure that the waste ink bottle is kept in a location inaccessible to children.
- Make sure to store waste ink, ink containers, cleaning solutions, pretreatment liquids, and any components that have come into contact with ink in a place that is inaccessible to children.
- When replacing a waste ink bottle, take care not to get any liquid on your clothing. If any spills occur, promptly wash the stained area with cold water.
- When replacing a waste ink bottle, ensure that you prevent any contact with your skin. In case of accidental contact, thoroughly cleanse the affected area with soap and water.
- When performing the following maintenance tasks, it is important to wear commercially available goggles and gloves.
- Cleaning the maintenance unit, head nozzle plate, wiper, left ink sump, encoder sheet, and guide rod.
- Replacing the left and right ink sump, ink supply unit, maintenance unit, ink cartridges, and waste ink bottle.

Information on the waste ink bottle

- Avoid opening the waste ink bottle unless it is necessary.
- Ensure that the waste ink bottle is installed in a vertical position to prevent leakage of waste ink.
- Make sure to securely fasten the waste ink bottle.

Proper Disposal of the Waste Ink and Waste Ink Bottle

Dispose of the waste ink and waste ink bottle in accordance with Follow the applicable laws and ordinances when disposing of the waste ink and waste ink bottle.

If you are unsure about the correct disposal method, seek guidance from your local dealer.

Appendix

How to Inquire

For inquiries, contact your sales or service representative.